

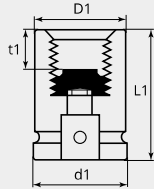

Stud bolt



Item number	Product header text	Product description	SW1	Drive	L1 (mm)
MO-1-M4	Impact socket, hexagonal, stud bolt M4, pitch 0.7	3/8 inch drive	M4	3/8	57
MO-1-M5	Impact socket, hexagonal, stud bolt M5, pitch 0.8	3/8 inch drive	M5	3/8	57
MO-1-M6	Impact socket, hexagonal, stud bolt M6, pitch 1.0	3/8 inch drive	M6	3/8	57
MO-1-M8	Impact socket, hexagonal, stud bolt M8, pitch 1.25	3/8 inch drive	M8	3/8	57
MO-1-M10	Impact socket, hexagonal, stud bolt M10, pitch 1.5	3/8 inch drive	M10	3/8	57
MO-1-M12	Impact socket, hexagonal, stud bolt M12, pitch 1.75	3/8 inch drive	M12	3/8	57
MO-4-M6	Impact socket, hexagonal, stud bolt M6, pitch 1.0	1/2 inch drive	M6	1/2	65
MO-4-M8	Impact socket, hexagonal, stud bolt M8, pitch 1.0	1/2 inch drive	M8	1/2	65
MO-4-M10	Impact socket, hexagonal, stud bolt M10, pitch 1.0	1/2 inch drive	M10	1/2	65
MO-4-M12	Impact socket, hexagonal, stud bolt M12, pitch 1.0	1/2 inch drive	M12	1/2	65
MO-4-M14	Impact socket, hexagonal, stud bolt M14, pitch 1.0	1/2 inch drive	M14	1/2	65
MO-4-M16	Impact socket, hexagonal, stud bolt M16, pitch 1.0	1/2 inch drive	M16	1/2	65
MO-4-M18	Impact socket, hexagonal, stud bolt M18, pitch 1.0	1/2 inch drive	M18	1/2	82
MO-4-M20	Impact socket, hexagonal, stud bolt M20, pitch 1.0	1/2 inch drive	M20	1/2	82
MO-4-M22	Impact socket, hexagonal, stud bolt M22, pitch 1.0	1/2 inch drive	M22	1/2	82
MO-4-M24	Impact socket, hexagonal, stud bolt M24, pitch 1.0	1/2 inch drive	M24	1/2	82
MO-4-M27	Impact socket, hexagonal, stud bolt M27, pitch 1.0	1/2 inch drive	M27	1/2	100
MO-4-M30	Impact socket, hexagonal, stud bolt M30, pitch 1.0	1/2 inch drive	M30	1/2	100
MO-4-M33	Impact socket, hexagonal, stud bolt M33, pitch 1.0	1/2 inch drive	M33	1/2	100
MO-4-M36	Impact socket, hexagonal, stud bolt M36, pitch 1.0	1/2 inch drive	M36	1/2	100
MO-4-M39	Impact socket, hexagonal, stud bolt M39, pitch 1.0	1/2 inch drive	M39	1/2	100
MO-4-M42	Impact socket, hexagonal, stud bolt M42, pitch 1.0	1/2 inch drive	M42	1/2	100